

The Basswood

QUALITY CONSTRUCTION
PARTNERS

Modern Comfort & Efficiency at an Affordable Price

Starting at \$299,000 | Includes Impact Windows & All Appliances

Discover *The Basswood*, a beautifully designed **3-bedroom, 2-bathroom** home that blends modern style with practical living. With **1,386 sq. ft. of living space**, this home offers a smart, open floor plan that maximizes comfort and efficiency.

Key Features:

Spacious Open Concept: The kitchen, dining, and living areas flow seamlessly for effortless entertaining.

Impact Windows & Doors: Enhanced safety and energy efficiency.

Fully Equipped Kitchen: Includes stainless steel appliances and sleek countertops.

Private Master Suite: Featuring a walk-in closet and ensuite bath for added comfort.

Covered Porch & Patio: Perfect for relaxing outdoors.

Two-Car Garage: Ample space for parking and storage. Ideal for first-time buyers, families, or anyone looking for **quality, efficiency, and value in a new home.**

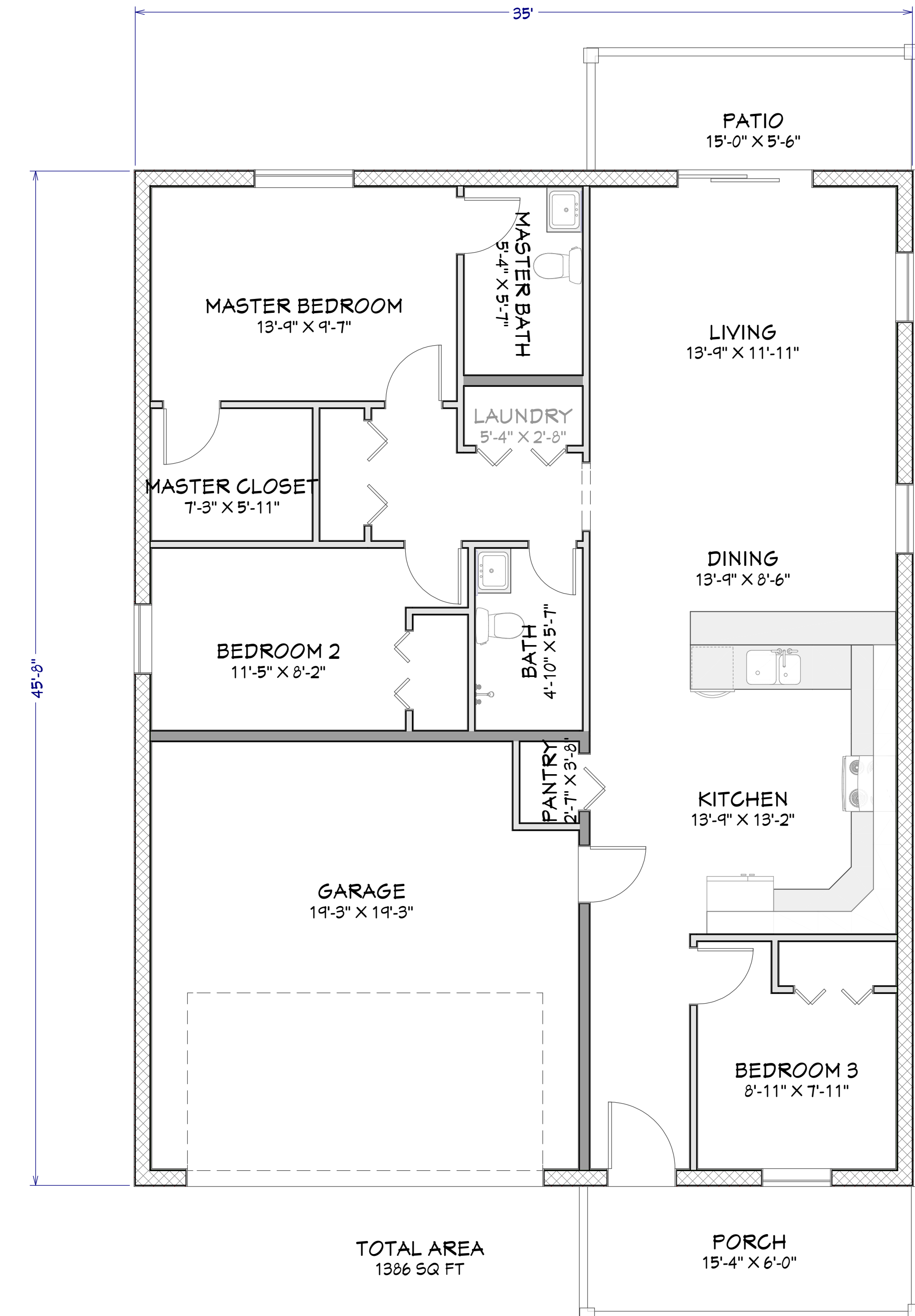

FLOOR PLAN VIEW SHELL
1/4 IN = 1 FT

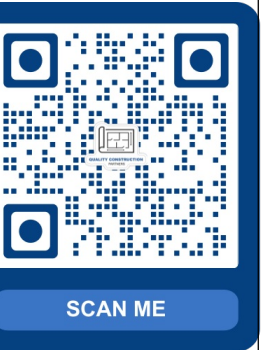

Page: Basswood Model Overview

BASSWOOD
MODEL

DRAWINGS PROVIDED BY:
QUALITY CONSTRUCTION PARTNERS LLC
ADMIN@QCPBUILDERS.COM

DATE:

3/17/2025

SCALE:

SHEET:

P-1

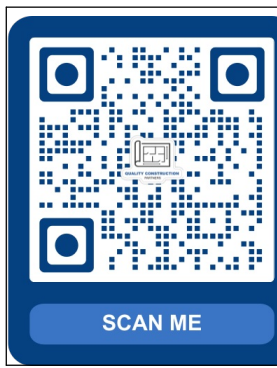

BASSWOOD MODEL

DRAWINGS PROVIDED BY:
QUALITY CONSTRUCTION PARTNERS LLC
ADMIN@QCPBUILDERS.COM

DATE:
3/17/2025

SCALE:

SHEET:
P-2

Key Features of The Basswood

- 3 Bedrooms, 2 Bathrooms** – A well-designed layout for comfortable living.
- 1,386 Sq. Ft. of Living Space** – Efficient use of space for modern lifestyles.
- Open-Concept Floor Plan** – Seamless flow between the kitchen, dining, and living areas.
- Impact Windows & Doors** – Enhanced storm protection, security, and energy efficiency.
- Fully Equipped Kitchen** – Includes all appliances, stylish cabinetry, and durable countertops.
- Spacious Master Suite** – Features a private bathroom and a walk-in closet.
- Laundry Room** – Convenient indoor space for washer and dryer.
- Covered Front Porch & Rear Patio** – Ideal for relaxing or entertaining.
- Attached Two-Car Garage** – Secure parking and extra storage space.
- Quality Finishes Throughout** – Modern flooring, lighting, and fixtures.





Exterior Features of The Basswood

 *The Basswood* offers a **modern yet timeless** exterior design, combining durability and curb appeal for a welcoming first impression.

Sleek & Sturdy Construction – Built with high-quality materials to ensure longevity and low maintenance.

Impact Windows & Doors – Providing enhanced safety, storm protection, and energy efficiency.

Elegant Covered Front Porch – A charming entryway with ample space for outdoor seating.

Spacious Two-Car Garage – Seamlessly integrated into the design for convenience and security.

Neutral-Toned Stucco Finish – A clean, contemporary aesthetic that complements any landscaping.

Architectural Gable Accents – Adding character and a stylish touch to the front elevation.

Professionally Landscaped Front Yard – Featuring neatly arranged greenery for a polished look.

Concrete Driveway & Walkway – Providing a smooth and durable entrance to the home.

Private Rear Patio – A great space for outdoor relaxation, grilling, or entertaining.

With its **modern appeal, functional design, and durable construction**, *The Basswood* is the perfect blend of style and practicality.

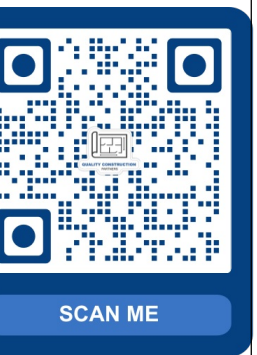



Interior Features of The Basswood

Step inside *The Basswood* and experience a **beautifully designed, modern interior** that balances functionality, comfort, and style.

Open-Concept Living Space – Seamless flow from the kitchen to the dining and living areas, perfect for entertaining.

Durable Laminated Flooring – Stylish wood-look laminate flooring throughout the home, offering durability and easy maintenance.

Fully Equipped Kitchen – Includes:

- Energy-efficient **refrigerator**
- Modern **electric range**
- Built-in **microwave**
- **Dishwasher** for added convenience
- Stylish **black granite countertops** complementing the white shaker-style cabinets

- **Spacious Master Suite** – Features a **private ensuite bath** with a **walk-in shower** and **modern vanity**.



- **Elegant Bathrooms** – Designed with **granite countertops, contemporary fixtures, and stylish tile work** in the showers.

Laundry Room – Dedicated space with hookups for a washer and dryer.

Energy-Efficient Impact Windows – Allowing for **natural light, security, and noise reduction**.

Recessed Lighting & Modern Fixtures – Enhancing the bright and inviting atmosphere.

Designed with **quality materials, modern appliances, and a comfortable layout**, *The Basswood* is **move-in ready and built to impress!**

